

UltraCut Reach 420 Art. 9705319-xx

**Remark:** "xx" stands for customer and country variants.  
The basic product number is before the hyphen.

**EN Operator's manual**  
Telescopic Battery Hedge Trimmer

---



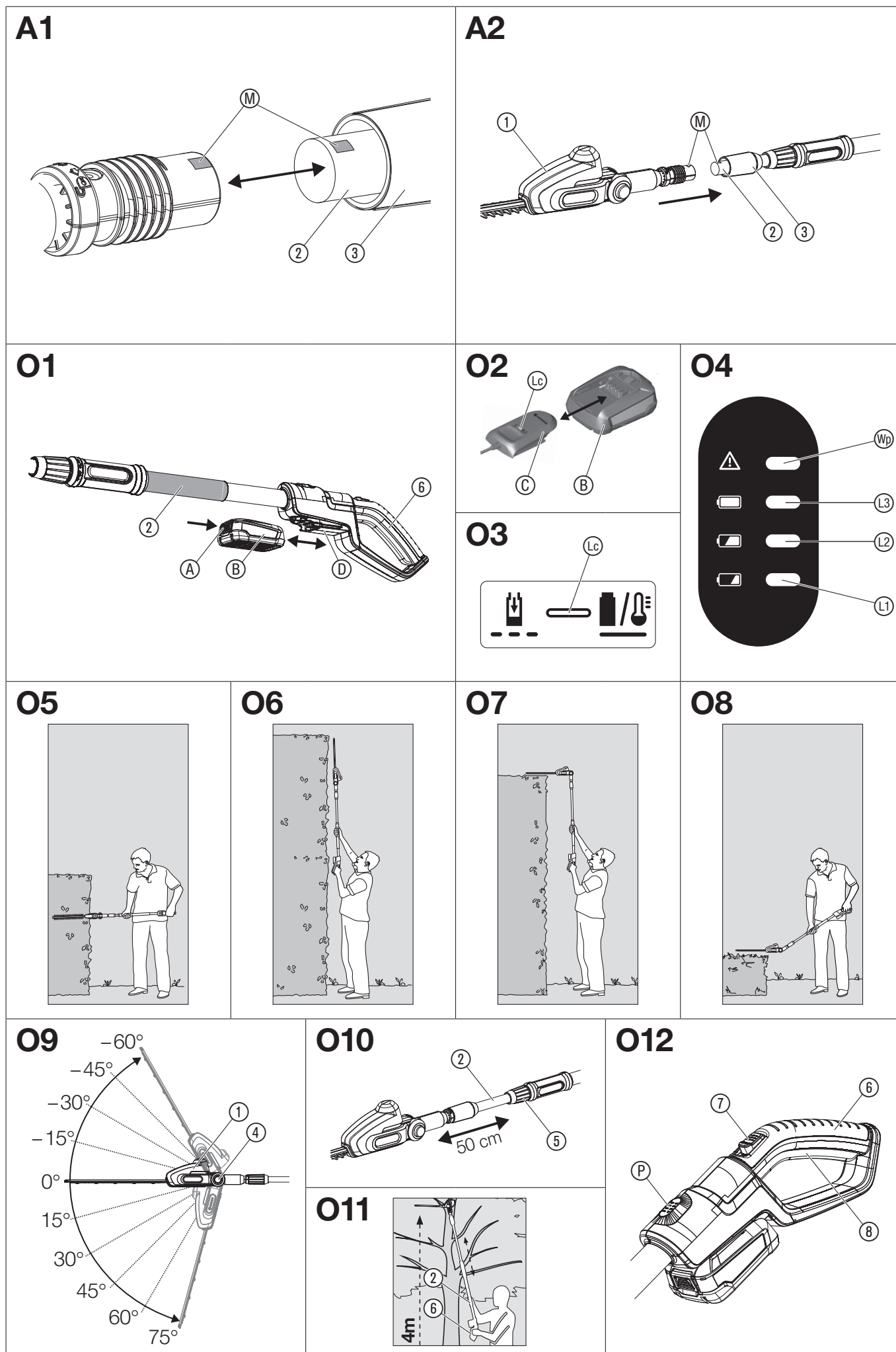

## EN Telescopic Battery Hedge Trimmer

1. SAFETY	4
2. ASSEMBLY	6
3. OPERATION	6
4. MAINTENANCE	7
5. STORAGE	7
6. TROUBLESHOOTING	7
7. TECHNICAL DATA	8
8. ACCESSORIES	8
9. SERVICE/WARRANTY	8

### Original instructions.



This product is not intended for use by persons (including children) with reduced physical, sensory or mental capabilities, or lack of experience and knowledge, unless they have been given supervision or instruction concerning use of the product by a person responsible for their safety. Children should be supervised to ensure that they do not play with the product. The use of this product by young people under the age of 16 is not recommended.

### Intended use:

The **FLYMO Telescopic Hedge Trimmer** is intended to cut hedges, shrubs and grass coverings in private domestic gardens and allotments. The product is not intended for long term use.



### DANGER! Risk of injury!

→ Do not use the product to cut lawns/lawn edges, to chop up material or to make compost. Do not use for pond care.

## 1. SAFETY

### IMPORTANT!

Read the operator's manual carefully before use and keep for future reference.

### Symbols on the product:



Read operator's manual.



Danger – Keep hands away from blade.



Do not expose to rain.



Wear eye and ear protection.



Always wear a hard hat.



Risk of fatal injury due to electric shock!  
Keep at least 10 m away from electricity lines.

### General safety warnings

#### General machine safety warnings



### WARNING!

Read all safety warnings, instructions, illustrations and specifications provided with this machine. Failure to follow the warnings and instructions may result in electric shock, fire and/or serious injury.

Save all warnings and instructions for future reference.

The term "machine" in the warnings refers to your mains operated (corded) machine or battery operated (cordless) machine.

#### 1) Work area safety

a) **Keep work area clean and well lit.** Cluttered or dark areas invite accidents.

b) **Do not operate machines in explosive atmospheres, such as in the presence of flammable liquids, gases or dust.**

*Machines create sparks which may ignite the dust or fumes.*

c) **Keep children and bystanders away while operating a machine.**

*Distractions can cause you to lose control.*

#### 2) Electrical safety

a) **Machine plugs must match the outlet. Never modify the plug in any way. Do not use any adaptor plugs with earthed (grounded) machines.**

*Unmodified plugs and matching outlets will reduce risk of electric shock.*

b) **Avoid body contact with earthed or grounded surfaces, such as pipes, radiators, ranges and refrigerators.** There is an increased risk of electric shock if your body is earthed or grounded.

c) **Do not expose machines to rain or wet conditions.**

*Water entering a machine will increase the risk of electric shock.*

d) **Do not abuse the cord. Never use the cord for carrying, pulling or unplugging the machine. Keep cord away from heat, oil, sharp edges or moving parts.**

*Damaged or entangled cords increase the risk of electric shock.*

e) **When operating a machine outdoors, use an extension cord suitable for outdoor use.**

*Use of a cord suitable for outdoor use reduces the risk of electric shock.*

f) **If operating a machine in a damp location is unavoidable, use a residual current device (RCD) protected supply.**

*Use of an RCD reduces the risk of electric shock.*

#### 3) Personal safety

a) **Stay alert, watch what you are doing and use common sense when operating a machine. Do not use a machine while you are tired or under the influence of drugs, alcohol or medication.** A moment of inattention while operating machines may result in serious personal injury.

b) **Use personal protective equipment. Always wear eye protection.**

*Protective equipment such as dust mask, non-skid safety shoes, hard hat, or hearing protection used for appropriate conditions will reduce personal injuries.*

c) **Prevent unintentional starting. Ensure the switch is in the OFF-position before connecting to power source and/or battery pack, picking up or carrying the machine.**

*Carrying machines with your finger on the switch or energising machines that have the switch on invites accidents.*

d) **Remove any adjusting key or wrench before turning the machine on.**

*A wrench or a key left attached to a rotating part of the machines may result in personal injury.*

e) **Do not overreach. Keep proper footing and balance at all times.**

*This enables better control of the machine in unexpected situations.*

f) **Dress properly. Do not wear loose clothing or jewellery. Keep your hair, clothing and gloves away from moving parts.**

*Loose clothes, jewellery or long hair can be caught in moving parts.*

g) **If devices are provided for the connection of dust extraction and collection facilities, ensure these are connected and properly used.**

*Use of dust collection can reduce dust-related hazards.*

h) **Do not let familiarity gained from frequent use of machines allow you to become complacent and ignore machine safety principles.**

*A careless action can cause severe injury within a fraction of a second.*

#### 4) Machine use and care

a) **Do not force the machine. Use the correct machine for your application.** The correct machine will do the job better and safer at the rate for which it was designed.

b) **Do not use the machine if the switch does not turn it on and off.**

*Any machine that cannot be controlled with the switch is dangerous and must be repaired.*

c) **Disconnect the plug from the power source and/or the battery pack from the machine before making any adjustments, changing accessories, or storing machines.** Such preventive safety measures reduce the risk of starting the machine accidentally.

d) **Store idle machines out of the reach of children and do not allow persons unfamiliar with the machine or these instructions to operate the machine.** Machines are dangerous in the hands of untrained users.

e) **Maintain machines. Check for misalignment or binding of moving parts, breakage of parts and any other condition that may affect the machine's operation. If damaged, have the machine repaired before use.** Many accidents are caused by poorly maintained machines.

f) **Keep cutting tools sharp and clean.** Properly maintained cutting tools with sharp cutting edges are less likely to bind and are easier to control.

g) **Use the machine, accessories and tool bits etc. in accordance with these instructions, taking into account the working conditions and the work to be performed.** Use of the machine for operations different from those intended could result in a hazardous situation.

h) **Keep handles and grasping surfaces dry, clean and free from oil and grease.** Slippery handles and grasping surfaces do not allow for safe handling and control of the machine in unexpected situations.

#### 5) Battery tool use and care

a) **Recharge only with the charger specified by the manufacturer.**

*A charger that is suitable for one type of battery pack may create a risk of fire when used with another battery pack.*

- b) **Use machines only with specifically designated battery packs.**  
*Use of any other battery packs may create a risk of injury and fire.*
- c) **When battery pack is not in use, keep it away from other metal objects, like paper clips, coins, keys, nails, screws or other small metal objects, that can make a connection from one terminal to another.**  
*Shorting the battery terminals together may cause burns or a fire.*
- d) **Under abusive conditions, liquid may be ejected from the battery; avoid contact. If contact accidentally occurs, flush with water. If liquid contacts eyes, additionally seek medical help.**  
*Liquid ejected from the battery may cause irritation or burns.*
- e) **Do not use a battery pack or tool that is damaged or modified.**  
*Damaged or modified batteries may exhibit unpredictable behavior resulting in fire, explosion or risk of injury.*
- f) **Do not expose a battery pack or tool to fire or excessive temperature.**  
*Exposure to fire or temperature above 130 °C may cause explosion.*
- g) **Follow all charging instructions and do not charge the battery pack or tool outside the temperature range specified in the instructions.**  
*Charging improperly or at temperatures outside the specified range may damage the battery and increase the risk of fire.*
- 6) **Service**
- a) **Have your machine serviced by a qualified repair person using only identical replacement parts.**  
*This will ensure that the safety of the machine is maintained.*
- b) **Never service damaged battery packs.** *Service of battery packs should only be performed by the manufacturer or authorised service providers.*

#### Hedge trimmer safety warnings

- a) **Keep all parts of the body away from the blade. Do not remove cut material or hold material to be cut when blades are moving.**  
*Blades continue to move after the switch is turned off. A moment of inattention while operating the hedge trimmer may result in serious personal injury.*
- b) **Carry the hedge trimmer by the handle with the blade stopped and taking care not to operate any power switch.**  
*Proper carrying of the hedge trimmer will decrease the risk of inadvertent starting and resultant personal injury from the blades.*
- c) **When transporting or storing the hedge trimmer, always fit the blade cover.** *Proper handling of the hedge trimmer will decrease the risk of personal injury from the blades.*
- d) **When clearing jammed material or servicing the unit, make sure all power switches are off and the battery pack is removed or disconnected.** *Unexpected actuation of the hedge trimmer while clearing jammed material or servicing may result in serious personal injury.*
- e) **When clearing jammed material or servicing the unit, make sure all power switches are off and the lock-off is in the locked position.**  
*Unexpected actuation of the hedge trimmer while clearing jammed material or servicing may result in serious personal injury.*
- f) **Hold the hedge trimmer by insulated gripping surfaces only, because the blade may contact hidden wiring.**  
*Blades contacting a "live" wire may make exposed metal parts of the hedge trimmer "live" and could give the operator an electric shock.*
- g) **Keep all power cords and cables away from cutting area.**  
*Power cords or cables may be hidden in hedges or bushes and can be accidentally cut by the blade.*
- h) **Do not use the hedge trimmer in bad weather conditions, especially when there is a risk of lightning.**  
*This decreases the risk of being struck by lightning.*

#### Extended-reach hedge trimmer safety warnings

- a) **To reduce the risk of electrocution, never use the extended-reach hedge trimmer near any electrical power lines.**  
*Contact with or use near power lines may cause serious injury or electric shock resulting in death.*
- b) **Always use two hands when operating the extended-reach hedge trimmer.**  
*Hold the extended-reach hedge trimmer with both hands to avoid loss of control.*
- c) **Always use head protection when operating the extended-reach hedge trimmer overhead.** *Falling debris can result in serious personal injury.*
- Search hedges and bushes for hidden objects (e.g. wire fences and hidden wires).  
The use of a residual current device (RCD) with a trip current of 30 mA or less is recommended.  
Hold the hedge trimmer with both hands on both handles.  
The hedge trimmer is intended for use when the user is standing on the ground and not on a ladder or other unstable surface.  
Before using the hedge trimmer, make sure that the locking devices of all moving parts (e.g. the extended shaft and the pivot element) are in the locked position.

#### Additional safety warnings

##### Battery safety



**Read all the safety and general instructions.**



Failure to observe the safety and general instructions may result in electric shock, fire and/or serious injury.

#### Store these instructions in a safe place.

Only use the charger if you can fully evaluate all functions and carry them out without restrictions, or if you have received corresponding instructions.

- **Supervise children during use, cleaning and maintenance.**  
This will ensure that children do not play with the charger.
- **Charge only lithium-ion batteries of the POWER FOR ALL system type PBA 18V with a capacity of 1.5 Ah or more (5 battery cells or more). The battery voltage must match the battery charging voltage of the charger. Do not charge any nonrechargeable batteries.**  
Otherwise there is a risk of fire and explosion.
-  **Do not expose the charger to rain or wet conditions.**  
Water entering a power tool will increase the risk of electric shock.
- **Keep the charger clean.** Dirt poses a risk of electric shock.
- **Always check the charger, cable and plug before use. Stop using the charger if you discover any damage. Do not open the charger yourself, and have it repaired only by a qualified specialist using only original replacement parts.**  
Damaged chargers, cables and plugs increase the risk of electric shock.
- **Do not operate the charger on an easily ignited surface (e.g. paper, textiles, etc.) or in a flammable environment.**  
There is a risk of fire due to the charger heating up during operation.
- In order to avoid safety hazards, if the power supply cord needs to be replaced, this must be done by FLYMO or by a customer service centre that is authorised to repair FLYMO power tools.
- **Do not operate the product while it is charging.**

**Products sold in GB only:** Your product is fitted with an BS 1363/A approved electric plug with internal fuse (ASTA approved to BS 1362). If the plug is not suitable for your socket outlets, it should be cut off and an appropriate plug fitted in its place by an authorised customer service agent. The replacement plug should have the same fuse rating as the original plug. The severed plug must be disposed of to avoid a possible shock hazard and should never be inserted into a mains socket elsewhere.

- **These safety warnings apply only for lithium-ion batteries of the POWER FOR ALL system PBA 18V.**
- **Only use the battery with products of the POWER FOR ALL system manufacturers.** This is the only way in which you can protect the battery against dangerous overload.
- **Recharge only with the charger specified by the manufacturer.**  
A charger that is suitable for one type of battery pack may create a risk of fire when used with another battery pack.
- **The battery is supplied partially charged.**  
To ensure full battery capacity, fully charge the battery in the charger before using your power tool for the first time.
- **Keep battery packs out of the reach of children.**
- **Do not open the battery.** There is a risk of short-circuiting.
- **In case of damage and improper use of the battery, vapours may be emitted. The battery can set alight or explode.**  
Ensure the area is well ventilated and seek medical attention should you experience any adverse effects. The vapours may irritate the respiratory system.
- **If used incorrectly or if the battery is damaged, flammable liquid may be ejected from the battery. Contact with this liquid should be avoided. If contact accidentally occurs, rinse off with water. If the liquid comes into contact with your eyes, seek additional medical attention.**  
Liquid ejected from the battery may cause irritation or burns.
- **If the battery is damaged liquid can be ejected and cover nearby surfaces. Check affected parts.**  
Clean these parts or change them if necessary.
- **Do not short-circuit the battery pack. When the battery pack is not in use, keep it away from other metal objects, like paper clips, coins, keys, nails, screws or other small metal objects, that can make a connection from one terminal to another.**  
Shorting the battery terminals together may cause burns or a fire.
- **The battery can be damaged by pointed objects such as nails or screwdrivers or by force applied externally.** An internal short circuit may occur, causing the battery to burn, smoke, explode or overheat.
- **Never service damaged battery packs.**  
Service of battery packs should only be performed by the manufacturer or authorized service providers.
-  **Protect the battery against heat, e.g. against continuous intense sunlight, fire, dirt, water and moisture.**  
 There is a risk of explosion and short-circuiting.
- **Only operate and store the battery at an ambient temperature between -20 °C and +50 °C.**  
Do not leave the battery in your car in the summer, for example.  
At temperatures of <0 °C some devices may experience a loss of power.
- **Only charge the battery at an ambient temperature which is between 0 °C and +45 °C.**  
Charging outside of this temperature range can increase the risk of damage to the battery and pose a fire hazard.

#### Electrical safety



**DANGER! Cardiac arrest!**

This product makes an electromagnetic field while it operates. This field may under some conditions interfere with active or passive medical implants. To decrease the risk of conditions that can possibly injure or

kill, we recommend persons with medical implants to speak with their physician and the medical implant manufacturer before you operate the product.

Only connect charger to the AC voltage specified on the rating plate.

Under no circumstances should an earth be connected to any part of the product.

Do not use the product when a thunderstorm is approaching.

Disconnect the product from the mains and disconnect the battery if the product starts to vibrate abnormally. Check immediately. Excessive vibration can cause injury. Protect the battery contacts from moisture.

#### Personal safety



#### DANGER! Risk of suffocation!

Small parts can be easily swallowed. There is also a risk that the poly-bag can suffocate toddlers. Keep toddlers away when you assemble the product.

Only use the product in the manner and for the functions described in these instructions. The operator or user is responsible for accidents or hazards occurring to other people or their property. Pay special attention to the hazard for third parties posed by the increased working radius when the telescopic tube is extended.



#### DANGER!

When wearing hearing protection, and due to the noise produced by the product, the operator may not notice persons approaching.

Always wear suitable clothing, gloves, and stout shoes.

Avoid contact to the oil of the blade in particular when you react allergic with it.

Check the areas where the hedge trimmer is to be used and remove any wires, hidden electrical cables and other foreign objects.

All adjustments (inclining the blade head, altering the length of the telescopic tube) have to be made with the sheath in place, and the Hedge Trimmer must not rest on the blade in the process.

Before using the machine and after any impact, check for signs of wear or damage.

Have the appropriate repair work carried out if necessary.

Never attempt to use an incomplete product or one with an unauthorised modification.

#### Power tool use and care

Know how to stop the product quickly in an emergency. Never hold the product by the protective cover.

Do not use the Hedge Trimmer if the protection equipment are damaged.

Do not use ladders whilst operating the hedge trimmer.

Always use the product when standing on solid ground.

Remove the battery:

- before leaving the hedge trimmer unattended for any period;
- before clearing a blockage;
- before checking, cleaning or working on the hedge trimmer;
- if you hit an object. Do not use your hedge trimmer until you are sure that the entire hedge trimmer is in a safe operating condition;
- if the hedge trimmer starts to vibrate abnormally. Check immediately. Excessive vibration can cause injury;
- before passing to another person.



#### RISK OF INJURY!

Do not touch the blade.

→ When work is finished or interrupted, refit the protective cover.

All nuts and screws must be firmly tightened to ensure a safe operating condition of the product.

If the product got hot during operation, let it cool down before storage.

The Hedge trimmer must not be stored over 35 °C or under direct exposure to sunlight.

Do not store the Hedge Trimmer in places with static electricity.

Beware of falling debris.

Only work in the daylight or when visibility is good.

## 2. ASSEMBLY



#### DANGER! Risk of injury!

Cut injury when the product starts accidentally.

→ Remove the battery and slide the protective cover over the blade before you assemble the product.

To assemble the telescopic handle [Fig. A1/A2]:

1. Slide the telescopic tube ② into the motor unit ① until you reach the stop position. The two markings ④ must be opposite from each other.
2. Tighten the grey nut ③.

## 3. OPERATION



#### DANGER! Risk of injury!

Cut injury when the product starts accidentally.

→ Wait for the blade to stop, remove the battery and slide the protective cover over the blade before you adjust or transport the product.

To charge the battery [Fig. O1/O2/O3]:



#### CAUTION!

→ Note the mains voltage! The voltage of the power source must match the voltage specified on the rating plate of the charger.

For the FLYMO Battery Hedge Trimmer Art. 9705319-xx there is no battery and no charger in the scope of delivery.

Thanks to the intelligent charging process, the charge condition of the battery is automatically detected and then charged up with the optimal charge current depending on battery temperature and voltage.

In this way, the battery is treated with care and remains permanently fully charged when it is stored in the charger.

1. Push the locking button ① and remove the battery ② from the battery holder ③.
2. Connect the battery charger ④ into a mains socket.
3. Slide the battery charger ④ onto the battery ②.

When the battery charge indicator ⑤ at the charger flashes green the battery is being charged.

When the battery charge indicator ⑤ at the charger illuminates permanently green the battery is completely charged (Charging time, see 7. TECHNICAL DATA).

4. Examine the charge status regularly while you charge.
5. When the battery ② is completely charged, you can disconnect the battery ② from the charger ④.

#### Meaning of the indication elements:

##### Indication on the charger:

**Flashing of the battery charge indicator ⑤** The charging procedure is indicated by flashing of the battery charge indicator ⑤.



**Note:** The charging procedure is only possible when the battery temperature is within the allowable charging temperature range, see 7. TECHNICAL DATA.

**Continuous lighting of the battery charge indicator ⑤**



**Continuous lighting** of the battery charge indicator ⑤ indicates that the battery is fully charged or that the temperature of the battery is not within the allowable charging temperature range and can therefore not be charged.

When the battery is not inserted, **continuous lighting** of the battery charge indicator ⑤ indicates that the mains plug is inserted in the socket outlet and that the battery charger is ready for operation.

Battery charge status indication ⑥ on the product [Fig. O4/O12]: After starting the product, the battery charge status indication ⑥ is displayed for 5 seconds.

Battery charge status	Battery charge status indication
67 – 100 % charged	①, ② and ③ illuminate green
34 – 66 % charged	① and ② illuminate green
11 – 33 % charged	① illuminates green
0 – 10 % charged	① flashes green

If the LED ① flashes green, the battery must be charged.

If the error LED ④ is illuminated or flashing, see 6. TROUBLESHOOTING.

#### Work positions:

The hedge trimmer can be operated in 4 positions.

**Side trimming:** Telescopic tube retracted [Fig. O5]

**Vertical trimming at high level:** Telescopic tube extended [Fig. O6]

**Horizontal trimming at high level:** Motor unit tilted by 75°, telescopic tube extended [Fig. O7]

**Low trimming:** Motor unit tilted by –60°, telescopic tube extended [Fig. O8]

**To tilt the motor unit [Fig. O9]:**

For trimming at high and low level, the motor unit ① can be tilted at an angle of 75° to -60° in 15° increments.

1. Keep both orange buttons ④ pushed and tilt the motor unit ① in the desired direction.
2. Release both orange buttons ④ and let the motor unit ① engage.

**To extend the telescopic tube [Fig. O10]:**

For cutting at high and low heights, the telescopic pipe ② can be continuously extended by up to 50 cm.

1. Loosen the orange nut ⑤.
2. Extend the telescopic tube ② to the desired length.
3. Tighten the orange nut ⑤ again.

**To start the hedge trimmer [Fig. O1/O11/O12]:****DANGER! Risk of injury!**

**Risk of injury if the product does not stop when you release the start lever.**

→ Do not bypass the safety devices or switches. For example do not attach the start lever to the handle.

**To start:**

The product is provided with a two-switch safety device (start lever with starting lockout) to prevent the product from being turned on by accident.

1. Put the battery ⑧ into the battery holder ⑩ until it audibly engages.
2. Remove the protective cover from the blade.
3. Hold the hedge trimmer with one hand on the insulated gripping surface on the telescopic tube ② and with the other hand on the handle ⑥.
4. Slide the starting lockout ⑦ forward and pull the start lever ⑧. *The hedge trimmer starts and the battery charge status indication ⑨ is displayed for 5 seconds.*
5. Release the starting lockout ⑦.

**To stop:**

1. Release the start lever ⑧. *The hedge trimmer stops.*
2. Slide the protective cover over the blade.
3. Push the locking button ① and remove the battery ⑧ from the battery holder ⑩.

## 4. MAINTENANCE

**DANGER! Risk of injury!**

**Cut injury when the product starts accidentally.**

→ Wait for the blade to stop, remove the battery and slide the protective cover over the blade before you maintain the product.

**To clean the Hedge Trimmer:****DANGER! Risk of injury!**

**Risk of injury and risk of damage to the product.**

→ Do not clean the product with water or with a water jet (in particular high-pressure water jet).  
→ Do not clean with chemicals including petrol or solvents. Some can destroy critical plastic parts.

**The airflow slots must always be clean.**

1. Clean the hedge trimmer with a damp cloth.
2. Clean the airflow slots with a soft brush (do not use a screwdriver).
3. Lubricate the blade with a low viscosity oil. *Avoid contact with the plastic parts.*

**To clean the battery and the battery charger:**

Make sure that the surface and the contacts of the battery and the battery charger always are clean and dry before you connect the battery charger.

**Do not use running water.**

→ **Battery charger:** Clean the contacts and the plastic parts with a soft and dry cloth.

→ **Battery:** Occasionally clean the ventilation slots and the terminals on the battery using a soft brush that is clean and dry.

## 5. STORAGE

**To put into storage:**

**The product must be stored away from children.**

1. Slide the protective cover over the blade.
2. Remove the battery.
3. Charge the battery.
4. Clean the hedge trimmer, the battery and the battery charger (see 4. MAINTENANCE).
5. Store the hedge trimmer, the battery and the battery charger in a dry, enclosed and frost-free place.

**Disposal:**

(in accordance with RL2012/19/EC/S.I. 2013 No. 3113)



The product must not be disposed of to normal household waste. It must be disposed of in line with local environmental regulations.

**IMPORTANT!**

→ Dispose of the product through or via your municipal recycling collection centre.

**Disposal of the battery:**

The FLYMO battery contains lithium-ion cells that should not be disposed of with normal household waste at the end of its life.

**Li-ion****IMPORTANT!**

→ Dispose of the batteries through or via your municipal recycling collection centre.

1. Discharge the lithium-ion cells completely (contact the FLYMO Service).
2. Protect the contacts on the lithium-ion cells against short circuits.
3. Dispose of the lithium-ion cells properly.

## 6. TROUBLESHOOTING

**DANGER! Risk of injury!**

**Cut injury when the product starts accidentally.**

→ Wait for the blade to stop, remove the battery and slide the protective cover over the blade before you troubleshoot the product.

Problem	Possible Cause	Remedy
Hedge trimmer can no longer be stopped	Start lever is stuck.	→ Remove the battery and loosen the start lever.
Hedge is not cleanly cut	Blade is blunt or damaged.	→ Let the blade be replaced by the FLYMO Service.
Hedge trimmer vibrates severely	Blade is damaged.	→ Switch off the product and let the blade be replaced.
Hedge trimmer does not start or stops. LED ① is flashing green [Fig. O4]	Battery is empty.	→ Charge the battery.
Hedge trimmer does not start or stops. Error-LED ② is illuminated red [Fig. O4]	Battery temperature is outside the permissible temperature range.	→ Wait until the battery temperature is between 0 °C – + 45 °C again.
	There are drops of water or moisture between the battery contacts on the hedge trimmer.	→ Remove the water drops/moisture with a dry cloth.
	Engine is blocked.	→ Remove the obstacle. Start again.
Hedge trimmer does not start or stops. Error-LED ② is flashing red [Fig. O4]	Product is defective.	→ Contact the FLYMO Service.

Problem	Possible Cause	Remedy
<b>Hedge trimmer does not start or stops. Error-LED (M) is not illuminated [Fig. 04]</b>	Battery is not put completely into the battery holder.	→ Put the battery completely into the battery holder until it audibly engages.
	Battery is defective.	→ Replace the battery.
	Product is defective.	→ Contact the FLYMO Service.
<b>Charging is not possible. Battery charge indicator (C) is continuously illuminated [Fig. 03]</b>	The battery is not connected (correctly).	→ Connect the battery to charger correctly.
	Battery contacts are dirty.	→ Clean the battery contacts (e. g. by connecting and disconnecting the battery several times. Replace the battery if necessary.
	Battery temperature is outside the permissible charging temperature range.	→ Wait until the battery temperature is between 0 °C – + 45 °C again.
	Battery is defective.	→ Replace the battery.
<b>Battery charge indicator (C) is not illuminated [Fig. 03]</b>	Mains plug of the charger is not (correctly) plugged in.	→ Insert the mains plug into the mains socket (completely).
	Socket outlet, mains cable or charger is defective.	→ Check the mains voltage. Let the charger be checked if necessary by an authorised specialist dealer or the FLYMO Service.



For any other malfunctions please contact the Husqvarna UK Ltd. Customer Service. Repairs must only be done by Husqvarna UK Ltd. service departments or specialist dealers approved by FLYMO.

## 7. TECHNICAL DATA

Telescopic Battery Hedge Trimmer	Unit	Value Art. 9705319-xx
Strokes	1/min	2100
Length of blade	cm	42
Tooth gap of blade	mm	16
Range of extension of the telescopic tube	cm	0 – 50
Weight (including battery)	kg	3.4
Sound pressure level $L_{pA}$ <sup>1)</sup> Uncertainty $k_{pA}$	dB (A)	72 3
Sound power level $L_{WA}$ <sup>2)</sup> : measured / guaranteed Uncertainty $k_{WA}$	dB (A)	87 / 90 3
Hand / arm vibration $a_{vhw}$ <sup>1)</sup> Uncertainty $k_{vhw}$	m/s <sup>2</sup>	1 1.5

Measuring process complying with: <sup>1)</sup>EN 62841-4-2 <sup>2)</sup>RL 2000/14/EC / S.I. 2001 No.1701



**NOTE:** The stated vibration emission value has been measured according to a standardized test procedure and can be used for comparison of one electric power tool with another. It can also be used for preliminary evaluation of exposure. The vibration emission value can vary during actual use of the electric power tool.

System Battery PBA 18V 2.5Ah W-B	Unit	Value (Art. 531382601)
Battery voltage	V (DC)	18
Battery capacity	Ah	2.5
Number of cells (Li-Ion)		5

Appropriate POWER FOR ALL system Battery Chargers:  
AL 1810 CV / AL 1815 CV / AL 1830 CV / AL 1880 CV.

Battery Charger AL 1810 CV P4A	Unit	Value (Art. 531382201)
Mains voltage	V (AC)	220 – 240
Mains frequency	Hz	50 – 60
Rated power	W	26
Battery charging voltage	V (DC)	18
Max. battery charging current	mA	1000

Battery Charger AL 1810 CV P4A	Unit	Value (Art. 531382201)
<b>Battery charging time 80% / 97 – 100% (approx.)</b>		
PBA 18V 2.0Ah W-B	min.	96 / 124
PBA 18V 2.5Ah W-B	min.	120 / 154
PBA 18V 4.0Ah W-C	min.	192 / 244

<b>Permitted charging temperature range</b>	°C	0 – 45
---------------------------------------------	----	--------

<b>Weight according to EPTA-Procedure 01:2014</b>	kg	0.17
---------------------------------------------------	----	------

<b>Protection class</b>	□ / II	
-------------------------	--------	--

Appropriate POWER FOR ALL system Batteries: PBA 18V.

## 8. ACCESSORIES

<b>GARDENA System Battery PBA 18V/45 P4A PBA 18V/72 P4A</b>	Battery for additional duration or for replacement.	<b>Art. 531382601 Art. 531382701</b>
<b>GARDENA Battery Charger AL 1810 CV P4A</b>	Charger for the POWER FOR ALL system Batteries PBA 18V..W-..	<b>Art. 531382201</b>

## 9. SERVICE/WARRANTY

### Service:

Please contact the address on the back page.

### Warranty statement:

In the event of a warranty claim, no charge is levied to you for the services provided.

Husqvarna UK Ltd. grants a warranty for all original FLYMO new products for two years from the date of original purchase from the retailer, provided that the devices have been for private use only. This manufacturer's warranty does not apply to products acquired second hand. This warranty includes all significant defects of the product that can be proved to be material or manufacturing faults. This warranty is fulfilled by supplying a fully functional replacement product or by repairing the faulty product sent to us free of charge; we reserve the right to choose between these options. This service is subject to the following provisions:

- The product has been used for its intended purpose as per the recommendations in the operating instructions.
- Neither the purchaser nor a third party has attempted to open or repair the product.
- Only Original FLYMO replacement parts and wear parts have been used for operation.
- Presentation of the receipt.

Normal wear and tear of parts and components (such as blades, blade fixing parts, turbines, light bulbs, V-belts/toothed belts, impellers, air filters, spark plugs), visual changes, wear parts and consumables are excluded from the warranty.

This manufacturer's warranty is limited to replacement and repair of products in accordance with the abovementioned conditions. The manufacturer's warranty does not constitute an entitlement to lodge other claims against us as a manufacturer, such as for damages. This manufacturer's warranty does **not**, of course, affect statutory and contractual warranty claims against the dealer/retailer.

The manufacturer's warranty is governed by the law of the Federal Republic of Germany.

In case of a warranty claim, please return the faulty product, together with a copy of the receipt and a description of the fault, with postage paid to the service address.

### Consumables:

The blade and excentric drive are consumables and are not included in the warranty.



## Product liability

In accordance with the German Product Liability Act, we hereby expressly declare that we accept no liability for damage incurred from our products where said products have not been properly repaired by a FLYMO-approved service partner or where original FLYMO parts or parts authorised by FLYMO were not used.

## EC Declaration of Conformity

The undersigned hereby certifies as the authorised representative of the manufacturer, Husqvarna AB, 561 82 Huskvarna, Sweden, that, when leaving our factory, the unit(s) indicated below is/are in accordance with the harmonised EU guidelines, EU standards of safety and product specific standards. This certificate becomes void if the unit(s) is/are modified without our approval.

Description of the product:	<b>18V UltraCut Reach</b>
Product type:	<b>420</b>
Article-Number:	<b>9705319-xx</b>
EC-Directives:	<b>2006/42/EC 2014/30/EU 2011/65/EU 2000/14/EC</b>
Harmonised EN:	<b>EN ISO 12100 EN 62841-1 EN 62841-4-2</b>
Deposited Documentation:	<b>GARDENA Technical Documentation, M. Jäger, 89079 Ulm</b>
Conformity Assessment according to	<b>2000/14/EC Procedure: art. 14 Annex V</b>
Noise level: measured/guaranteed	<b>87 dB(A) / 90 dB(A)</b>

Ulm, 31.12.2021

Authorised representative:



**Reinhard Pompe**  
Vice President Products



**Wolfgang Engelhardt**  
Vice President Supply Chain

## UKCA Declaration of Conformity

---

The manufacturer: Husqvarna AB, SE 561 82 Huskvarna, Sweden hereby certifies, when leaving our factory, the unit(s) indicated below is/are in accordance with the UK Regulations, designated standards of safety and product specific designated standards. This certificate becomes void if the units are modified without our approval.

Description of the Product:	<b>18V UltraCut Reach</b>
Product type:	<b>420</b>
Article Number:	<b>9705319-xx</b>
UK regulations:	<b>S.I. 2008/1597 S.I. 2016/1091 S.I. 2012/3032 S.I. 2001/1701</b>
Designated Standards:	<b>EN ISO 12100 EN 62841-1 EN 62841-4-2</b>
Authorised Representative:	<b>Husqvarna UK Limited</b>
Deposited Documentation:	<b>Preston Road, Aycliffe, County Durham UK DL5 6 UP</b>
Noise level: measured / guaranteed	<b>87 dB(A) / 90 dB(A)</b>
Conformity Assessment according to:	<b>According to S.I. 2001/1701 Art. 11 Schedule 8</b>

Aycliffe, 31.12.2021

Authorised Representative:



**John Thompson**  
Director







Service Address and Importer to

**Great Britain**

Husqvarna UK Ltd  
Preston Road  
Aycliffe Industrial Park  
Newton Aycliffe  
County Durham  
DL5 6UP  
Phone: +44 (0) 344 844 4558  
customer.services@husqvarna.co.uk



32420-85.960.01/1021  
Husqvarna AB  
Drottninggatan 2  
SE-561 82 Huskvarna  
Sweden

Our policy of continuous improvement means that the specification of products may be altered from time to time without prior notice.

Copyright © 2021 Flymo S.A. All rights reserved.

Flymo® and other product and feature names are registered or unregistered trademarks of Flymo S.A.